



**“STATIC” Panel climbing wall System  
Indoor Locations  
Operations Manual**



**REVISION 6/09/16  
17511 99<sup>th</sup> Road  
Miami, FL 33157**

**Tel (305) 238-4522 Fax (305) 238-4401**

**Web Page [www.verticalreality.com](http://www.verticalreality.com)**

**Email: [albert@verticalreality.com](mailto:albert@verticalreality.com)**

## Welcome

It is with great pleasure that we congratulate you on your climbing wall purchase and welcome you to Vertical Reality, Inc. We are excited about our products and feel confident that through proper planning, placement and hard work, the Static climbing wall will be a rewarding and profitable purchase. Our philosophy is centered on a commitment to excellence in meeting the needs of our customers, providing a quality product that is safe, exciting and profitable. We encourage you to likewise develop a standard of quality and service that makes you the leader in supplying artificial Static climbing walls for the amusement, entertainment and special attractions market.

Our goal is to establish a relationship with your company. One that will promote Vertical Reality and your company, as successful partners, providing entertainment for those whom are looking for a climbing attraction.

*Our part in making our team successful is:*

- Commitment to proper, effective, Safe and profitable design
- Seven days per week customer service support
- Manufacturing to "ASTM F-1159-16" safety standards for the amusement industry
- Cycle time that generates high profits

*Your part in building a successful business using Vertical Reality products is:*

- Commitment to safe operation
- Consistent inspection for proper maintenance
- Effective marketing and promotion
- Active promotion of the activity

We are looking forward to a long and prosperous relationship. Should you have any comments or questions, please do not hesitate in calling.

Sincerely,

Ken A Sharkey  
President                      CEO

# Confidentiality Agreement

This manual and the content within this manual are for the exclusive use and operation of the climbing wall product by the owner of the climbing wall and its authorized personnel and for Vertical Reality, Inc. This manual is designed to provide accurate and authoritative information in regard to the subject matter covered. This manual may not be reproduced in whole or part in any form or by any means, without the prior written consent of **Vertical Reality, Inc.**

## **Confidentiality**

This manual contains proprietary information belonging to Vertical Reality, Inc. It is to be viewed only by persons employed by Vertical Reality, Inc. and/or the climbing wall owner and authorized personnel.

## **Distribution**

This manual is not to be distributed to any other persons other than those actively engaged in the operating and/or marketing of the climbing wall product to customers serviced by the owner of the Static climbing wall Static climbing wall.

## **Disposition**

This manual is the property of the Static climbing wall owner and Vertical Reality, Inc. and must be returned to Vertical Reality, Inc. upon receipt of an updated manual or discarded.

## **Revision**

Vertical Reality, Inc. may make periodic additions, deletions and modifications to this manual. These updates will, in the judgment of Vertical Reality, Inc., add to the quality of services offered. This manual must be kept up to date, and should reflect all updates currently in use.

## **Notice of Changes**

In the event that revisions are made to this manual, Vertical Reality, Inc. will send the appropriate pages reflecting such changes as are deemed necessary or replacement document, to the individual for replacement. Any pages that are then outdated must be destroyed and discarded.

In the event of replacement pages are sent, Vertical Reality, Inc. will provide a cover letter outlining the revision and the effective date of any procedural changes.

## Receipt and Acknowledgment

This Training/Operations Manual is an important document intended to help you become acquainted with the Static climbing wall, Vertical Reality, Inc. and guidelines as to safe and recommended operation.

Please read the following statement and sign below to indicate your receipt and acknowledgment of the Static climbing wall/Vertical Reality, Inc. Training Manual.

I have received and read my copy of the Static climbing wall/Vertical Reality, Inc. Training Manual. I understand that the information outlined in this manual are subject to change at the sole discretion of Vertical Reality at any time. It is further understood that the owner of the Static climbing wall has the responsibility to ensure the correct and latest version of the manual is being used.

As an owner of the Static climbing wall or authorized representative, it is my responsibility to

Keep this manual up-to-date with any changes that are made by Vertical Reality, Inc.

I understand that my signature below indicates that I have received the Static climbing wall/Vertical Reality, Inc. Training Manual and that I have read it.

Authorized Representative

Date

The signed original copy of this agreement will be held in the **Corporate Office in Miami, FL**

**Receipt and Acknowledgment and Warrantee registration**  
**PLEASE FILL IN AND MAIL TO VERTICAL REALITY**

This Training/Operations Manual is an important document intended to help you become acquainted with the Static climbing wall, Vertical Reality, Inc. and guidelines as to safe and recommended operation.

Please read the following statement and sign below to indicate your receipt and acknowledgment of the Static climbing wall/Vertical Reality, Inc. Training Manual.

I have received and read my copy of the Static climbing wall/Vertical Reality, Inc. Training Manual. I understand that the information outlined in this manual are subject to change at the sole discretion of Vertical Reality at any time. It is further understood that the owner of the Static climbing wall has the responsibility to ensure the correct and latest version of the manual is being used.

As an owner of the Static climbing wall or authorized representative, it is my responsibility to

Keep this manual up-to-date with any changes that are made by Vertical Reality, Inc.

I understand that my signature below indicates that I have received the Static climbing wall/Vertical Reality, Inc. Training Manual and that I have read it.

Authorized Representative

Date

VIN / Serial No  
DATE PURCHASED

The signed original copy of this agreement will be held in the **Corporate Office in Miami, FL**

## Training Overview

This training course is an introduction to the **Static climbing wall** and its operation. The purpose of this manual is to provide a compilation of information that will assist you in proper and safe operation.

This manual is designed to aid in training you and your associates. The sections within this manual are prerequisite to each other. In other words, the information in section one pertains to the information in section two.

The philosophy of **Vertical Reality** is centered on a commitment to excellence in meeting the needs of its customers and associates by providing them with the enclosed information.

The manual is designed to provide the wall owner with the information, tips, and techniques that will help the employees and owner operate the wall as effectively and safely as possible. It is no way a total representation of all facts. Safe operation of this wall is the sole responsibility of the wall owner/operator. Good and reasonable judgement must be used when traveling, promoting and/or operating the wall.

## Training Objectives

Upon reviewing this training, you will be able to complete the following:

- Explain specific information regarding the background and history of Vertical Reality, Inc.
- Understand the process for proper set-up of the Static climbing wall
- Identify and understand the inspection points for day-to-day maintenance.
- Define and understand the safe operation of the Static climbing wall.
- Identify and explain the rules for safe usage of the Static climbing wall.

### Company Overview

Vertical Reality, Inc., located in Miami, FL is a manufacturer/ distributor of commercial interactive sports and fitness-fun equipment used in the amusement and recreational fitness markets. Designed for fun, VR is a premier provider of commercial action based products to be used in the amusement, fitness and recreation industry. Safely engineered VR products provide maximum revenue while providing thousands of hours of safe and exciting entertainment for your customers.

### Mission Statement

To be the premier provider of revenue-generating *interactive sports* products used in the amusement and fitness markets.

### Corporate Values

Our philosophy is centered on a commitment to excellence in meeting the needs of our customers, providing a quality product that is safe, exciting and profitable.

## ***Static climbing wall***

### Product Overview

Welcome to the Static climbing wall, one of Vertical Reality's revenue generating interactive sports products designed for the amusement, entertainment, and fitness industries. Complete with redundant auto-belay devices, the Static climbing wall maximizes profit and safety. Different from other climbing walls, the Static climbing wall does not use, what is commonly termed as, and a person for belaying. The reason for this is because of the autobelay devices. With the auto-belay devices doing all of the belay work and ensuring safety, the person(s) operating the wall act more like a coach offering encouragement and direction. The Static climbing wall is designed to meet ASTM F-1159-16 standards for the Amusement Industry. This means that the Static climbing wall is designed, manufactured, tested, and supported by comprehensive quality assurance and quality control measures to ensure product reliability and safety. The enclosed information is an outline as to the procedures for safe operation and set-up of the product.

### Warranty (from date of invoice)

***WARNING – Failure to follow the operational requirements found in your Operation and Owner's Manual will result in voiding warranties and will place people and property at risk of serious damage and injuries. Any modifications, alterations, misuse, work or service that is performed on your Vertical Reality MFG Inc equipment or its components that is not performed by an authorized Vertical Reality MFG Inc employee voids any and all claims to any manufacturer's liability.***

***It is the buyer/operator's responsibility to know and understand all regulatory restrictions and limitations that apply to this product in their jurisdiction. VR makes no guarantee, explicit or implied, that the product meets all requirements in the buyer/operator's jurisdiction.***

**WARRANTIES.** Seller warrants that all Goods shall be free of defects in material and workmanship ROCK WALL products have a limited one-year warranty on the climbing wall systems including the frame, and panels. Warranty does not include consumables (harnesses, handholds, cables, pulleys, Batteries, tires these are covered by the individual respective manufacturer's warranties). We have a 90-day warranty on electronics, 30-days on labor, 90-day on parts. This warranty does not apply towards normal wear and tear on products nor does it apply towards misuse on products. Auto-belay systems are warranted for the original purchaser(s) for one year (does not include auto-belay cable or pulleys).

Rock Climbing is a dangerous sport. Whether you are climbing outdoors, on a Static product, or in a gym, they are all considered dangerous without the proper training and safety practices. The purchasers and users of our products are completely liable for and accept full responsibility for any and all damages or injury, which may result from the use and/or misuse of any products

The Seller makes no warranties, expressed or implied, except as specifically stated above. SUCH WARRANTIES ARE IN LIEU OF ALL OTHER WARRANTIES, WRITTEN OR ORAL, STATUTORY, EXPRESS OR IMPLIED, INCLUDING WITHOUT LIMITATION, ANY WARRANTY OF MERCHANTABILITY OR FITNESS FOR A PARTICULAR PURPOSE.

SELLER SHALL IN NO EVENT BE LIABLE FOR ANY INCIDENTAL, SPECIAL, OR CONSEQUENTIAL DAMAGES OF ANY NATURE, EVEN IF SELLER HAS BEEN ADVISED OF THE POSSIBILITY OF SUCH DAMAGES.

The Seller shall only be obligated to repair a defective item. If the item(s) cannot be repaired, the Seller shall only be obligated to pay damages up to an amount equal to the sale price of the item(s).

## What is an "Auto-Belay?"

### The Belay

In order to understand the term auto-belay, we must first define the term belayer respective to traditional rock climbing. The act of belaying can be defined as a procedure of securing a climber by the use of a rope. In recreational sport climbing there are generally two people involved in a climb. A climber, the person climbing the intended surface or structure, and the person whom is providing the safety for the climber known as a belayer. The belayer's role is to use two hands on a braking device, which controls the descent of the climber. One of the functions of the belayer is to ensure the rope slack is taken up as the climber ascends and ensure that the rope does not get tangled up which would result in the climber dangling. Once the climber asks to come down, it is the function of the belayer to allow the rope to pass through the braking device such that the climber descends at a rate that is not too fast or too slow.

The biggest fears in manually lowering someone as a belayer, is that a belayer could drop the climber out of control, or let the end of the rope pass through the belay device such that the climber falls to the ground. Both of these mistakes have often happened, and to very experienced climbers



### Auto-Belay

Vertical Reality, Inc. is using the term "auto-belay" to describe its automated belaying process. Rather than a person acting as the belayer, Vertical Reality uses a pressurized air/oil hydraulic system that automatically controls the rate of descent when a climber falls or chooses to come down off the wall. The intended function of the automated belaying system is to take up the slack in the climbing cable as the person climbs. As a climber climbs the wall, the climber will take weight off of the cable, in which the positive air pressure in the hydraulic system causes the cable to retract or to functionally take up the cable slack. This works by air pressure forcing the hydraulic fluid into the pistons the whole sequence is reversed for the controlled decent of the climber. A human person in the sport of traditional rock climbing generally performs this function. However, the auto belay system used by Vertical Reality provides a system that automates this function. The automated system eliminates the need to rely upon a human belayer for every climber rather; allowing a single person (belayer or instructor) to supervise all three climbers. This ensures safe and proper climbing eliminating the use of a human belayer. The Static climbing wall with its auto belay devices allows for four climbers to climb the wall simultaneously with only one person acting as a belaying coach. Whereas in traditional rock climbing, every climber would require a belayer. This simple feature means that when operating a wall for profit, the Static climbing wall generates more profit than a wall requiring human belayer's by simply reducing the amount of labor needed to operate the wall.

### Safety Standards

Is the auto belay safer than a human belayer? Vertical Reality, Inc. answers this question by manufacturing their Static climbing wall product with two hydraulic cylinders for every climber. Two cylinders mean that a redundant system is in parallel, which will ensure that if one hydraulic cylinder fails, a second system will take up the slack and function in a safe manner. In comparison to recreational climbing using manual belayer's, six belayer's would be required to belay for three climbers. This means that there would be two belayer's for every climber. Imagine the payroll requirement you would need on a manual system to compare with the safety system featured in the Static climbing wall Climbing Structure. However, in fairness, rock climbing has its inherent risks. A participant climbing on the Static climbing wall can be injured. Even though the Static climbing wall system is automated, we require that a responsible person be assigned to ensure that the mechanical function of the Static climbing wall is operating properly. As an owner of the Static climbing wall, it is your responsibility to make sure constant care and supervision is taken regarding the operation of this product.

### **How to set-up the Static climbing wall**

#### **INSTALLED PERMANENTLY BY VERTICAL REALITY**

This wall is custom made in pieces for easier transport and erection.

This wall has a custom frame behind the wall for added support.

There are two ways to erect this wall.

The first way is to assemble the wall completely once it is in position on floor. You can hoist the complete structure into an upright position then secure it to the floor.

The second way is to assemble the base and a frame secure it to the floor then Drop the next Piece on top of the base then the final piece on top of the second piece.

Each piece is bolted to the bottom piece with 4 bolts (supplied and in place)

Do not substitute bolts for the ones supplied unless you are sure of the same grade.  
See diagram for approximate placement of brackets. Drill holes in concrete floor and use the Supplied anchors to secure base frame to the ground.  
Bolt Fiberglass panels together at the flange  
Bolt top Davit Arms to top Frame.

*Required Personnel* - The Static climbing wall can be operated with only one person. However, for proper operation, Vertical Reality recommends that at least two people operate the attraction for optimal performance and safety. Vertical Reality recommends that one-person act as the climbing coach supervising any one or all three of the climbers and a second person to harness the climber and obtain a parental consent or hold harmless signature. The climbing coach should offer encouragement, entertain the climber and most importantly watch the belay cable to ensure that there is no excess slack in the cable or that the climber does not out climb the auto-belay device. The second person in charge of harnessing should ensure the Harness is worn correctly.

Pull the auto belay cables from the top of the wall and secure to the climbing anchors on the bottom of the wall.

Check that the auto belays are functioning properly and pull them up and down a few times so the hydraulic oil will fill up the cylinders (bleed the system).

**Absolutely no climbing should be performed on the wall if the auto-belay is not functioning.** Make sure to always inspect the Auto-Belay devices to ensure proper air-tank pressure (40 - 50 lbs.) with all the cables at the top of the wall, hydraulic leaks pulley condition, the belay cable is taking up slack, etc.

### **Inspections and Preventive Maintenance**

#### ***Daily Inspections (Must be performed before any one is allowed to climb)***

As a means of properly maintaining the Static climbing wall and ensuring proper safety for the climber a daily inspection is required. **Cables must be inspected daily. If fraying or rusting has occurred, replace the cable immediately. Inspect the cable ends by the crimps. If fraying or Rusting broken strands, replace immediately. If the cables are kinked or show signs of wear, replace them as a matter of precaution. With one operator on the front of the wall, manually extend each cable all the way out and slowly let the cable go back up while a second person inspects the retraction of the cable to ensure there is NO SLACK behind the wall. This must be done for every belay station before any one is allowed to climb. If cable fails to retract do not use that station and call Vertical Reality!**

Check each and every harness to ensure the stitching is tight and that the harness is in good working order. If the harnesses are visibly worn or are not functioning as intended discard immediately and replace with new harness. As a matter of precaution, you may want to replace the climbing harnesses yearly. For proper function of the auto belay system, make sure that the air pressure is between 40 lbs. and 50 lbs. with the cables at the top of the wall. Inspect daily for oil leaks, should a leak occur call Vertical Reality for details. **The appropriate amount of**

hydraulic fluid is 3 to 5 inches from the bottom of tank with the cables at the top of the wall and should be AW 32 hydraulic oil. If you have any questions, please call Vertical Reality. If equipped, make sure to check the function of the swivels on each cable end. Make sure the swivels turn freely and are in good condition. **Check Carabineer's to ensure they function properly. If they stick open or do not lock positively, replace immediately. Check Carabineers for excessive wear, if worn replace immediately.** Lastly, make sure the handholds on the wall are tight. If any of the handholds spin or are loose, tighten them. With all parts supplied from other manufacturers besides Vertical Reality (i.e. harnesses, Carabineer's, swivels) make sure to read and understand their respective warnings and instructions. **Auto bailey Piston head bracket, must be inspected and nuts checked for tightness. All ½ bolts must also be inspected for rust and condition. If replacement is deemed necessary, it must be replaced with a grade 8 bolt only and nylon jam nut.**

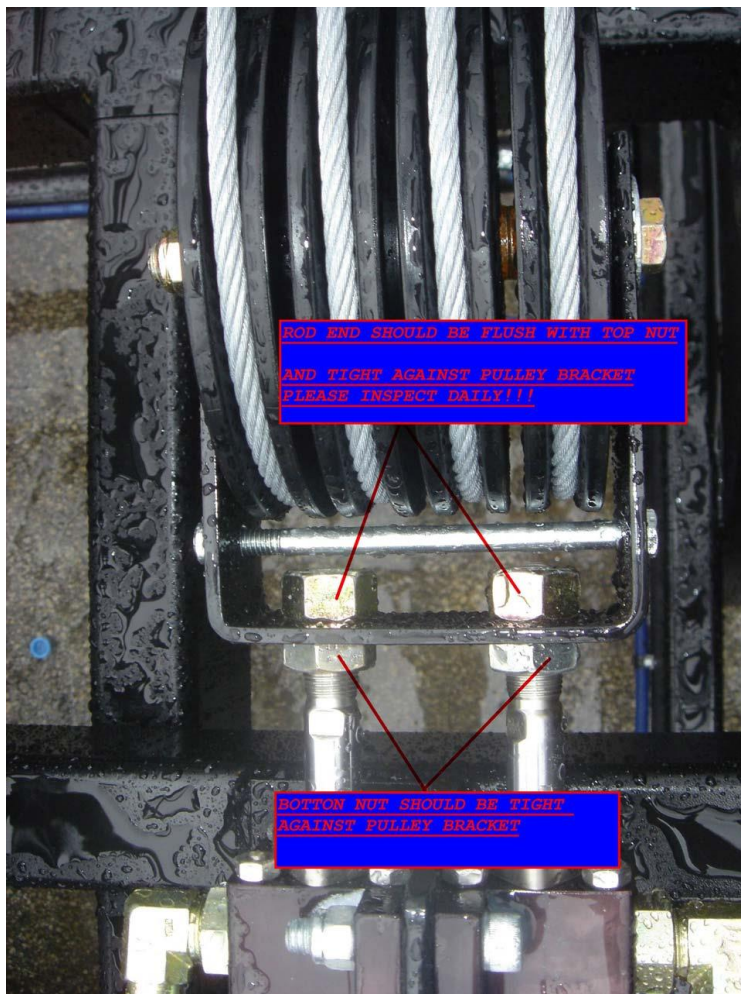

Make sure that the recommended safety matt is located around the wall to cover all climbing lanes. Inspect matt for damage or tears, repair or replace matt if damage is detected.

## *Weekly Inspections*

Inspect pulleys once a week. The auto belay pulleys are at eye level and can be inspected from the ground. For the guide pulleys at the top of the wall must be inspected by climbing up the front of the wall and inspecting from the front. Tie one end of the belay rope to the Carabineer's end of the belay cable. Release the cable, while controlling the ascent with the rope, and let the cable travel to the top of the wall. Make sure there is a smooth ascent and while pulling on the rope, a smooth descent (retraction of cable). The purpose of this exercise is to ensure that the mechanical function of the auto-belay is operating properly. If you experience any slack, call Vertical Reality for advice and instructions.

Check pulley Movement and also check the condition of the welds on the pulley brackets and pulley bar, if there is evidence of rust please have the unit inspected to check that the welds are still 100 %. **Auto Bailey Piston head bracket, must be inspected and nuts checked for tightness. All ½ bolts must also be inspected for rust and condition. If replacement is deemed necessary, it must be replaced with a grade 8 bolt only and nylon jam nut.**

## **NDT requirements**

- Rides will require a 100% visual inspection at 10 years of age by a certified welder. Particular attention to all the structural welds on the trailer and metal condition.
- Rides will require a 100% visual and 30% magnetic particle test at five years of age by a certified testing company.

### *Wear Dated Items*

The following items are wear-dated items along with suggested guidelines for replacement:

- *Carabineer's* - It is well known that equipment deteriorates progressively with use. It is difficult to give a precise lifetime because it depends on the environment where it is being used. Surface damage, corrosive wear, mechanical wear, or impairment of the mechanical function of the product is easily observed.
- *Swivels* - Again, the same warning for the Carabineer's apply to the swivels.
- *Pulleys* - Replace when worn
- ***Cables* -annually (every 12 months or 10000 cycles whichever comes first regardless of condition) or 10000 cycles if equipped with a counter or sooner if frayed / rusted or kinked or crimps show signs of deterioration. Cables must be purchased pre-assembled from Vertical Reality or installed by an approved Vertical Reality MFG representative.**
- *Handholds* - As needed. Handholds wear out on a regular basis, call Vertical Reality for replacements.
- *Harnesses* - Replace when the fabric has visible cuts, tears, abrasion and/or damage caused by

use, heat chemicals etc. The stitching is cut, torn worn or loose threads. Or, when the buckles are not functioning properly

### Day-to-Day Operations

Now that the Static climbing wall is set-up and ready for operation, you've performed the appropriate inspections, it's time to address the issues of proper climbing.

*Equipment* - All climbing runs are set up with auto locking Carabineer's. We strongly recommend auto-locking Carabineer's because of the safety feature of the auto-locking mechanism. In addition, we strongly recommend that our own VR climbing harness be used. This particular harness does not require a double-over requirement for securing the strap that other climbing harnesses require. Not only is the VR a safer harness, it is a harness that participants can secure with little help from the climbing coach because the harness is more straightforward and simpler to fasten. **We recommend that a gym matt cover an area of at least 4ft around the entire climbing panel. The gym matt covering the surface of the landing area must meet, or exceed, the impact attenuation requirements of ASTM F 1292 for a height of at least six feet must be used.** Any of these products can be ordered from Vertical Reality for approximately the same cost, as any local climbing retail store would offer.

For maximum through-put, we recommend that a second person (harness assistant) other than the climbing/belay coach make sure the climbing harnesses are tight and secure and are being worn properly. Having several climbers harnessed and ready to go ahead of time will result in maximum utilization of the wall.

*Belay Coach & Harness Assistant*- The belay/climbing coach is responsible for proper climbing. It is his/her role to ensure that the participant understands the rules and double checks the harness and equipment to check for appropriate wear and function. The belay coach is responsible to make sure that there is NO CABLE SLACK in the climbing line. In addition, the belay coach should be the ONLY non-climbing person in the 8' rappelling area in front of the wall. At Vertical Reality, we refer to this area as the "Climbing Zone" and its purpose is to provide a safe area whereby a climber can rappel without fear of coming down onto another person. The belay coach has the responsibility to ensure that each climber is safely directed out of the climbing zone, back to the harness area for removal of the harness after his or her completed or attempted climb. The belay coach should

Offer positive words of encouragement to both climbers and spectators. The more fun the belay coach can make the experience for the climber, the more enjoyable the event will be for the participant. Happy customers result in repeat business. The belay coach will be asked questions from the crowd and should try to answer questions without taking their eyes off the climber. In an effort to assist the belay coach, the harness assistant should try to address all questions, if possible. This will allow the belay/climbing coach can manage the climbers on the wall effectively.

*Harness assistant* - This person's responsibility is to make sure the harness is being worn correctly for climbing. This person should make sure the appropriate harness is worn correctly (i.e. small children in a children's harness, a small to large person in the adult large harness, and a large adult in the adult extra-large harness). In addition, the harness assistant should recite the rules to the climber such that after the belay coach reviews the rules, each climber will have heard the rules twice. The harness assistant should try to take an active role in answering all questions from the crowd so that the belay coaches' attention is with the climbers. The harness assistant should always watch the wall in an effort to assist the climbing/belay coach in proper climbing. Harness instructions are on next page.

### User Instructions and Fitting:

All harnesses are size specific. Please ensure your harness is sized properly. (Diagram 1)

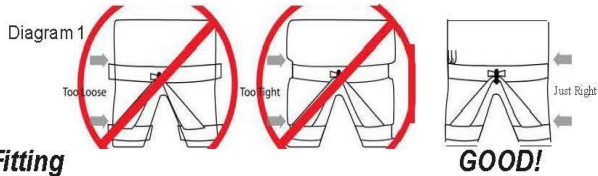

#### Fitting

1. Remove harness from bag and ensure that there are no twists.
2. Identify the front and back. The front has the large loop for the carabiner.
3. Step into the leg loops and waist loop of the harness and pull the leg loops up to the tops of your thighs. Adjust and tighten the waist loop first, ensuring it sits above the hip bones. Then adjust and tighten leg loops and shoulder/chest straps. Adjust the elastic "seat strap" to ensure the leg loops do not slip while climbing.
4. Buckle the waistbands securely and leaving at least 3 inches of nylon after the buckle.
5. Harnesses are one size fits all.
6. Make sure the harness fits properly (Diagram 1).

#### Tie-In:

The tie-in points on the harness are indicated in the following diagrams. This is the only way to safely tie in. Use only approved knots/carabiners for tying in. Improper tie in whether partially tied knot, unsafe knot, tying or clipping into wrong point/scan result in severe injury or death.

#### Buckles:

These harnesses can be equipped with three different buckle types, **double back**, **fast pass** and **quick release**.

**Double back** buckles need to be retreaded back through the buckle (see Diagram 2)

**Fast Pass** buckles lock down automatically when threaded properly. Please ensure your buckles are threaded and working properly. (Diagram 3) **Quick release** buckles must be adjusted and sized properly before each use. (Diagram 4)

Diagram 2



Diagram 3

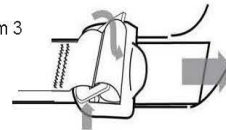
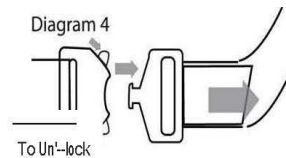

Diagram 4



### Weather Considerations for Outdoor Installations.

- DO NOT operate the wall if wind speeds exceed 40 mph. It is the responsibility of the operator, climbing coach, owner, or other responsible party to be aware of weather conditions and make the appropriate call for closure of the wall if necessary.
- Do not operate if it is raining, snowing or hailing.
- Do not operate if lightning is visible.
- Do not operate if severe weather is imminent.

**Rules and Safety Tips** - First, insure the climbing coach has double-checked the wearing of the harness and has properly instructed the climber on the climbing rules; which are:

- Climbers stay within the respective climbing route, generally marked with different color handholds. If matching handholds, the four-foot area directly under the belay cable outlines the climbing area.
- No swinging from side to side.
- Make sure the safety matt is in place before you climb.

- No stepping on the belay cable.
- No climbing if cable does not retract.
- Communications with the climbing coach only, no distracting other climbers with idle conversation.
- When rappelling, keep the kick-off distance to a minimum (approximately. 2 - 3 feet from the wall).
- No climbing with shoes without toes or toe protection (i.e. no sandals, thongs, etc.).
- DO NOT allow a climber to climb beyond the wall top. A climber should never climb higher than chest high to the top of the wall.
- The weight range for the wall is 40 - 250lbs & a Minimum Height 42". It is possible for a child weighing less than 40 lbs. to climb the wall as long as the climbing harness is properly fitted. However, the climbing rope provided with the unit may need to be attached to the child's harness and the child pulled down after the climb.
- Do not sit our bounce on the belay cable when finished rappelling.
- Please rappel and land on your feet.

As a note, it may be necessary for the climbing coach to climb the wall to retrieve a child who may be frozen in place afraid to come down after they have climbed to whatever height.

By way of recommendation, as the climber climbs the wall, the belay coach should be interactive by offering positive words of encouragement and possible hand or foothold selection. As a climber rappels after having climbed to the top, make sure the area on the ground is free of any individual who could possibly get in the way of the repelling climber. The distance we recommend approximately. Eight (8) feet from the front surface of the Static climbing wall. The only person who should be in this eight-foot area is the climbing coach. Upon the completion of a climb, the climber must wait for direction from the climbing coach before proceeding to the harness area for removal of the climbing harness. Likewise, the upcoming climber must be advised by either the climbing coach or the second person ensuring proper fitting of the harness before proceeding to climb on the wall. This will ensure that a rappelling climber will not descend onto an upcoming climber. *As an additional note, although Climbing Helmets are not required, we strongly recommend their use.*

*Entertainment Tips* - Never forget that your Static climbing wall is a fun attraction and will draw attention. Use this unique feature to book company picnics, birthday parties, corporate promotion events, special events, public attractions, fairs and festivals to name a few. Never forget that the wall can be equipped for corporate advertising generating revenue up and above the charge by the climb revenue. The belay coach should be someone who enjoys people and has a positive rapport with people making your attraction fun for the entire family. Remember that this wall was not necessarily designed for climbers. Route the wall for the intended market - those who have always wanted to give rock climbing a try. The Static climbing wall is a product designed for fun!

## **Marketing ideas to Consider**

This information is in no way comprehensive. It is a dynamic list that keeps growing. However, for the purpose of brainstorming and generating ideas, the following are marketing considerations.

- Corporate Sponsorship
- Sports Event Marketing
- Fairs
- Parties
- Charity Events
- Graduation Parties
- Tourist Attractions
- Trade Shows
- School Events
- Amusement Park Lease
- Street Festivals
- Radio and Television Station promotion
- Etc.

Make sure to work with your local Chamber of Commerce, Convention Bureaus, Non-profit Organizations and Advertising/Public Relations Firms to ensure your wall is marketed to its fullest.

## **Conclusion**

This guideline has been written to assist in the proper installation and operation of the Static climbing wall. Vertical Reality has tried in its best effort to address relative issues; however, there will be additional information learned or situations that occur that we are unaware of at this time. Please, do not hesitate to call seven days a week with any technical question. Remember, there may be questions, issues and/or concerns that may arise through the use of this product that are not listed or addressed in this manual, please keep us informed. It is the responsibility of the owner and/or operator of this product to contact Vertical Reality, Inc. if any questions or concerns arise. As with any amusement device, physical harm can occur and operators and participants must realize that this product is a physical activity and that proper care should be taken to ensure safety. Please exercise good common sense and good judgment while operating and transporting the Static climbing wall.



## **EMERGENCY PROCEDURES**

**In the event of an accident, there is a very well established set of guidelines created to help staff deal with the situation on. Our goal is to take care of any emergency in a quick and appropriate manner. Take charge of the situation and remain calm at all times.**

### **FIRE**

**If there is a fire near or around the Rockwall, the staff on site should:**

- **Call 911 and request assistance.**
- **Evacuate everyone in the area of the climbing structure, if indoors a safe area away from the Building.**
- **Make sure no one approaches the Rockwall again until the situation has been contained and controlled, and the proper authorities determine it is safe to do so.**
- **Notify the GM to come to the scene and represent the Rockwall.**

### **INJURY**

**If there is an accident at the Rockwall that causes an injury the staff on site should:**

- **Call 911 and request assistance - THIS MUST ALWAYS BE DONE!!**  
**Allow the injured party to deny Emergency Medical Service if they choose to. However, we must always make that call.**

**Static climbing Wall  
Preventative Maintenance  
Schedule**

***Inspection Date:***

***Inspected by:***

**Daily**

Auto-Belay Cable - Check cable for fraying, rust, if frayed or rusted, replace cable.

Auto-Belay Cable Ends - Ensure that there are no broken strands by crimp.

Auto-Belay Cables are tracking along pulleys without restriction.

Ensure there is no cable slack in front or behind the wall.

Ensure that the oil level has at least 3 inches in the tank with all 3 or 4 routes at the top

Harness Stitching - If stitching is pulling apart, send to Vertical Reality for inspection or repair or **replace immediately**.

Air Tank Pressure - Pressure Gauge reading between 40 psi. - 50 psi. With cables at top of wall, Hydraulic Fluid level minimum of 3 and a max of 6 inches from the bottom of the tank with the cables at the top.

Carabineer's - If the auto locking Carabiner's is not locking positively or sticking open, **replace immediately**.

Ensure the swivel turns freely. If your wall has no-twist cable (wall without swivels) refer back to cable inspections.

Check Nuts on Rod end of cylinders Shaft that hold the pulley head bracket they are tight, and not becoming loose

**Weekly**

Pulley Wear - Inspect pulley's closely to ensure proper function, replace if worn.

Trailer frame and pulley bar assembly to be checked for proper attachment and weld condition annually with a magnetic particle test.

Hydraulic Hose - Inspect for road damage and proper function. No leaks!

Tire Pressure - On Static units, check tire for proper pressure

Cable slack - With rope; test the full length to ensure proper auto belay function.

Note: Please make copies from this page and use as directed!

Thank you and have Fun!

## Accident Report Form

We anticipate that you never will have to use this form, however in the unlikely event of an accident, please fill out the following details and fax to us ASAP at 305-238-4401

- Date of accident
- Place of accident
- Time of accident
- Name of injured person
- Address of injured person
- Phone of injured person
- Was 911 called and please attach a copy of the report
- Extent and nature of injury
- What caused the accident
- Was the person intoxicated or under the influence of alcohol or drugs
- Were Vertical Reality's safety rules posted
- Was your staff properly trained in the operation of the wall
- Was the wall shut down for inspection after the accident occurred
- Name of person signing the report
- Signature



Miami, FL 33152  
 Tel (305) 238-4522 Fax (305) 238-4401 Toll free (877) 632-6444  
[www.vertical-reality.com](http://www.vertical-reality.com)

Monday, August 05, 2019

ROCK WALL INSPECTION REPORT	
DATE	
VIN NO	
OWNER	
Check Cable for signs of rust total length	
Check Cable Crimps	
Date of last cable change	
Hoses tightened on all belay system	
Oil level in belay tank with cables at the top	
Pressure in belay tank with cables at the top	
Belay system checked for proper operation	
Cables retracting evenly and smoothly	
Check for rust on belay cylinders	
check welds on top pulley bracket assembly	
Harnesses in good shape no signs of loose stitching	
Carabiners working and not worn out	
Check nuts that attach pulley bracket to rod ends	

Inspectors Name	
Phone number	
Signature	